

“The fact is that the Design Kitchen experience is sort of a clean sheet of paper where you say ‘let’s go design something and make it work.’” —Ken Oshman ’62

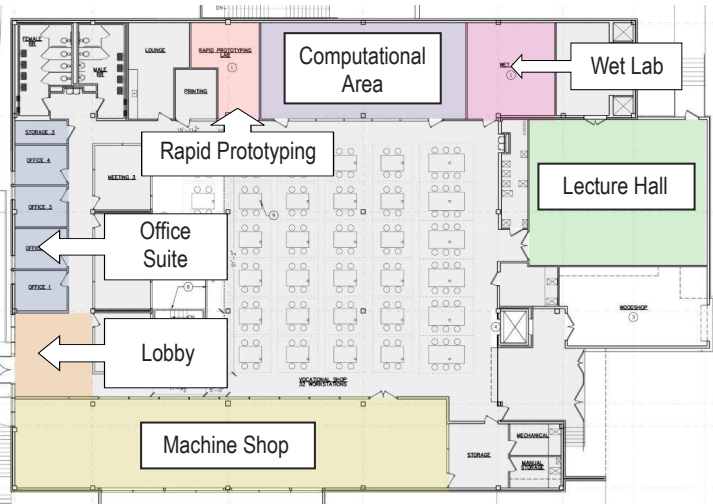

OEDK FIRST FLOOR

Computational Area — \$300,000

Expands a highly utilized space from 16 computer work stations to more than 24 stations.

Lecture Hall — \$250,000

Equipped with a projector and white board, 24 moveable tables and seating for 48-60 students. Utilized for freshman and senior design courses.

Machine Shop — \$250,000

Equipped with 5 lathes, 3 drill presses, 2 vertical mills, a band saw, grinders, buffers and compressed air and specialty tools.

Office Suite (4) — \$150,000 or \$50,000 per office

A suite consisting of four offices housing the OEDK director, associate director, design technician and administrative coordinator.

Chemical Wet Lab — \$150,000

Work tables with microscopes, chemical storage, chemical-proof sink, chemical hood, assorted lab and glassware, and wet-lab-specific safety gear.

Expanded Rapid Prototyping Area — NAMED

For rapid prototyping tasks such as laser cutters, 3D printers and a foam cutter.

Building Leaders: The RCEL Challenge

All gifts made to the OEDK are counted toward the matching gift challenge offered by John ’73 and Ann ’75 Doerr, who share Rice’s vision of preparing future engineers to lead efforts to solve global problems. If Rice raises \$10 million for the Rice Center for Engineering Leadership by June 30, 2013, then Mr. and Mrs. Doerr will make an additional contribution of \$5 million.

OEDK EXPANSION

Team Prototyping Area/Stairwell — \$750,000

Expands the current prototyping space by adding more than 24 work tables and additional equipment and resources. Connects to the upper level with a large open stairwell.

Electronics Prototyping Lab — \$250,000

Quadruples the size of the current electronics space. Outfitted with electronics equipment, and includes a large closet for additional storage of valuable equipment.

Conference Room — \$125,000

Seats 16–18 people. Equipped with the latest presentation technologies.

Internet Lounge — \$75,000

Features internet terminals stocked with the latest engineering software for any engineering student to access during times when the computer lab is in session.

Coffee Bar — \$50,000

A vibrant, centrally located space that features a coffee bar to keep students energized and focused.

Offices (2) — \$50,000 each

New staff or faculty offices to house the growing OEDK team.

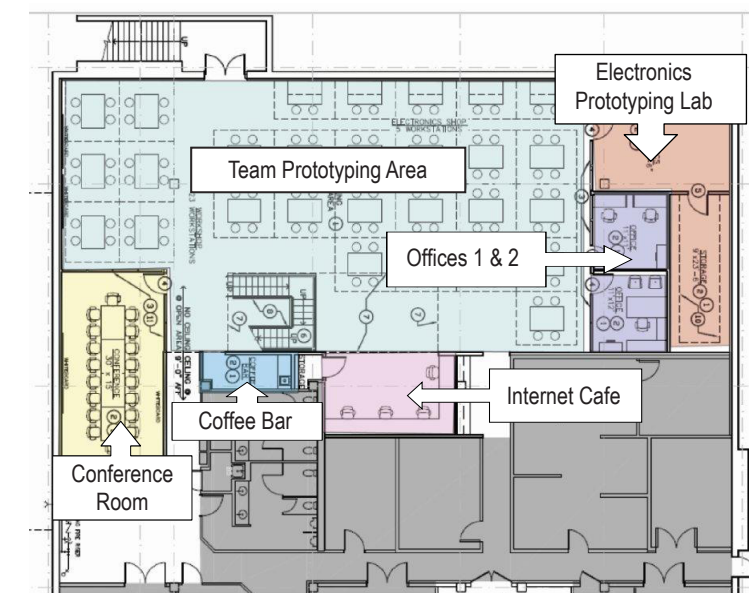

The demand for space in the OEDK has increased rapidly along with the growth of undergraduate enrollment at Rice and the incredible success of our design teams. Expansion of the OEDK facility will allow us to meet this demand by increasing our design team tables from 38 to more than 60.

